

Amerikanische wissenschaftliche Bibliotheken bilden neue Räume für die digitalen Wissenschaften

Ein Vergleich der neuen Bibliotheksräume und
Angebote im Triangle Research Libraries Network
(TRLN) in North Carolina

Heidi Madden und Nele Fritz

16.3.2016

Triangle Research Libraries Network

([Webseite TRLN](#))



TRIANGLE RESEARCH LIBRARIES NETWORK

DUKE UNIVERSITY NORTH CAROLINA CENTRAL UNIVERSITY NC STATE UNIVERSITY UNIVERSITY OF NORTH CAROLINA AT CHAPEL HILL

SEARCH TRLN

- Duke University
- North Carolina Central University (NCCU)
- North Carolina State University (NCSU)
- The University of North Carolina at Chapel Hill (UNC)

Definition: Research Commons

Mit “Research-Commons” bezeichnet man einen Bibliotheksraum, der interdisziplinäre, daten-gesteuerte, und auf digitales Format angewiesene Forschung & Forschungsteams unterstützt und fördert.

Dienstleistungen - Abgrenzung von:

Auskunft

- Reference Desk
- Research Services Desk
- Information Kiosk
- Circulation Desk
- Help Desk

Technik

- Multimedia Project Studio
- The Center for Instructional Technology
- The Digital Scholarship Center
- The Digital Production Center
- Makerspace
- Innovation lab
- Smart Classroom ([Duke LINK](#))

Namensgebung - Abgrenzung von:

First Year
Writing Center

Office of
Information
Technology

The Edge

Forschungs-Commons
Duke University Libraries

Humanities
Laboratory

Wired Lab

The Foundry

Duke Immersive
Virtual
Environment

DIVE Duke
Smart House

Wandel der Nutzerbedürfnisse

Traditionelle Auskunft



sinkende Nachfrage im Gebäude

- 
- **Datenmanagement**
Management, GIS, Visualisierung, Text-Mining, Erwerb / Lizenzierung , Software, Hardware
 - **wissenschaftliche Kommunikation**
Repositorien, Open Access, Urheberrecht und Copyright Beratung, Evaluation von Standards
 - **Forschungsdatenmanagement**
Projektmanagement, Archivierung
 - **Digitalisierung**
Scanning, OCR
 - **digitale Werkzeuge + Training**
Wissenschaftsdesign, Projektmanagement, Literaturverwaltung, Online-Zusammenarbeit, Online-Ausstellungen
 - **virtuelle Auskunft**
Email, Chat, Telefon

Duke University Libraries – Planungsprozess 2011 - 2015

2011

- Bauplanungsteam berufen

2012

- “Visioning Workshop”

2014

- Namensgebung nach Spender + “The Edge”

2014

- Bauprozess

2015

- Offizielle Eröffnung

Prozess Edge – Modelle in den USA



University of Virginia
Scholars Lab



University of Illinois
Scholarly Commons



Emory University Library Learning
Commons

Emory University Library Digital
Scholarship



University of Washington
Libraries Research Common



NEW YORK UNIVERSITY

New York University Bobst
Library Research Commons



Columbia University Digital
Science Center

Columbia University Digital
Social Science Center

Skilling-Up / Fortbildung



[Breaking the Code. The Developing Librarian Project](#)



[UVa Praxis Program · The Praxis Network](#)



[Research Now: Cross-Training for Digital Scholarship Home](#)

Personal: Duke Beispiel

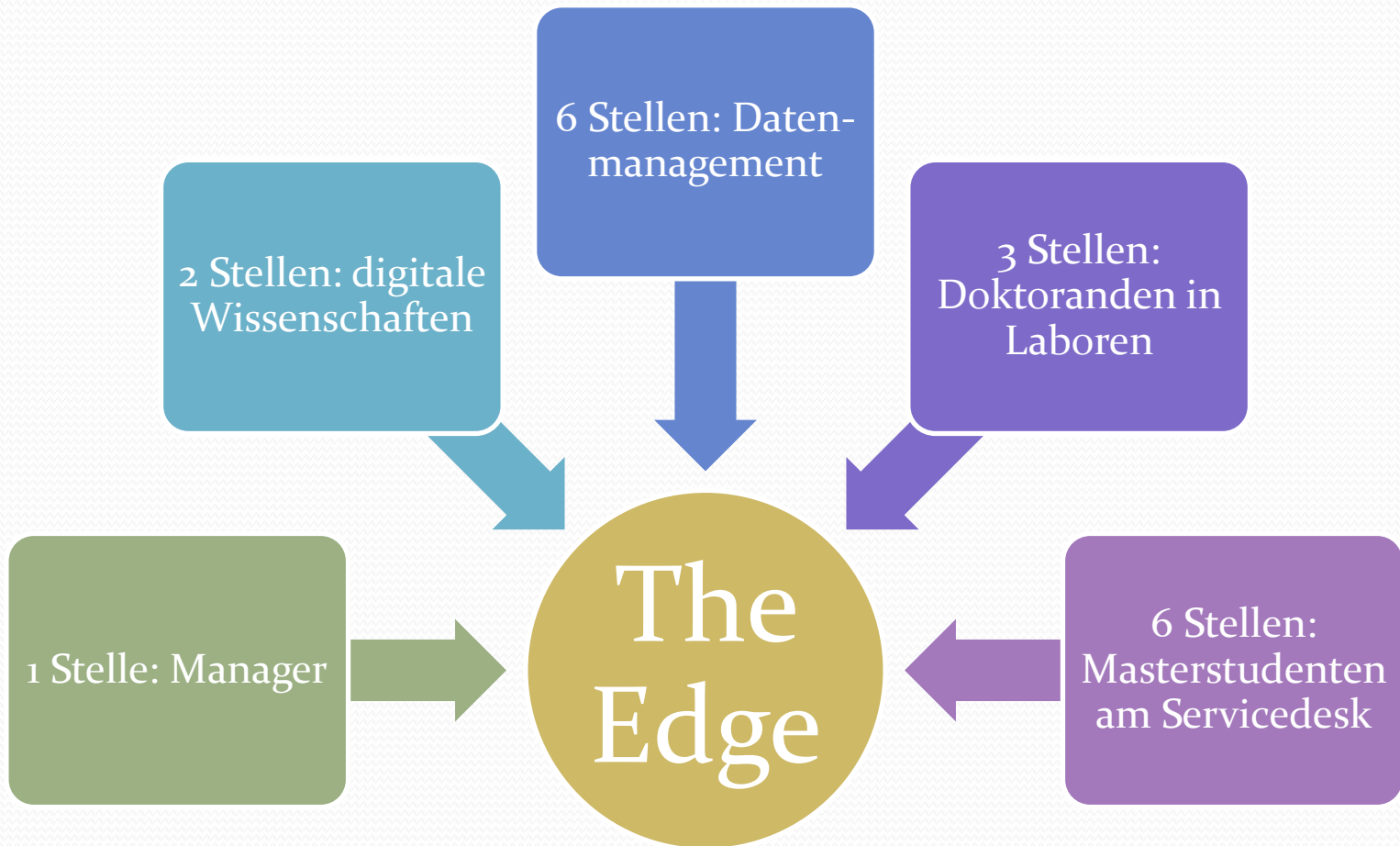

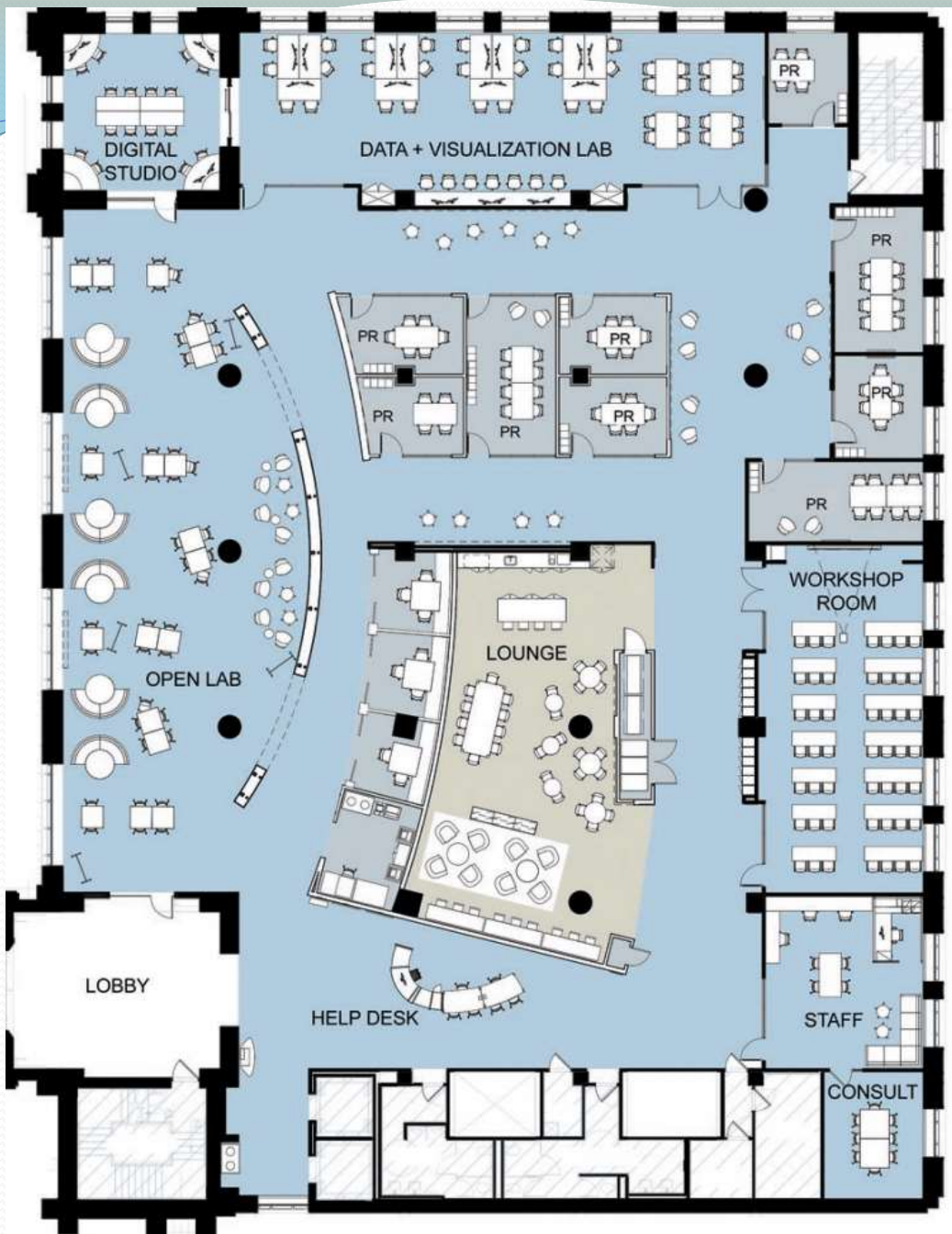

Raumplan

Ca. 1310m²
14100ft²

The / **EDGE**

The Ruppert Commons for
Research + Technology + Collaboration

Eingang

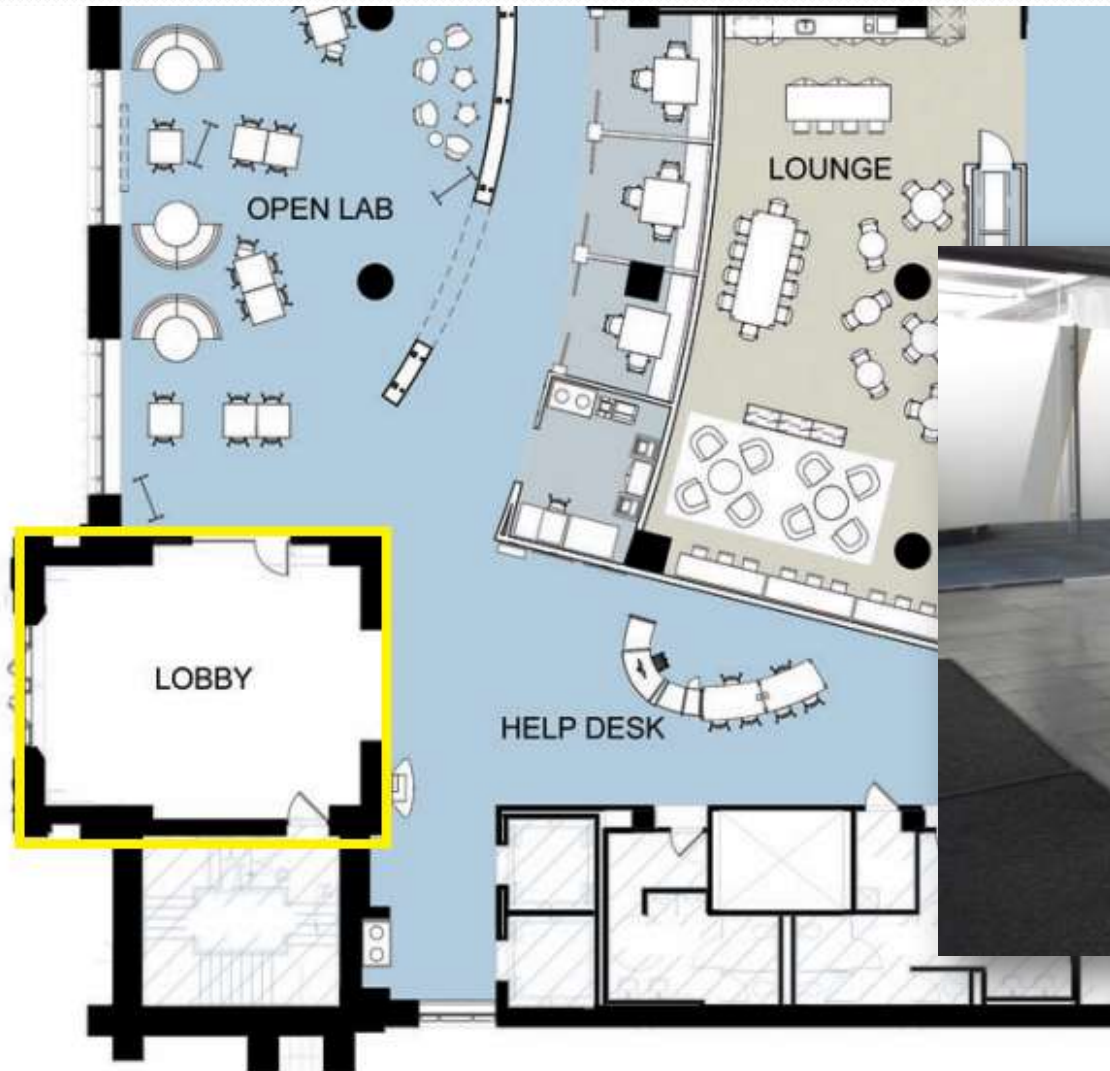

Servicedesk/ Auskunft

Fischer-Zernin Family Help Desk

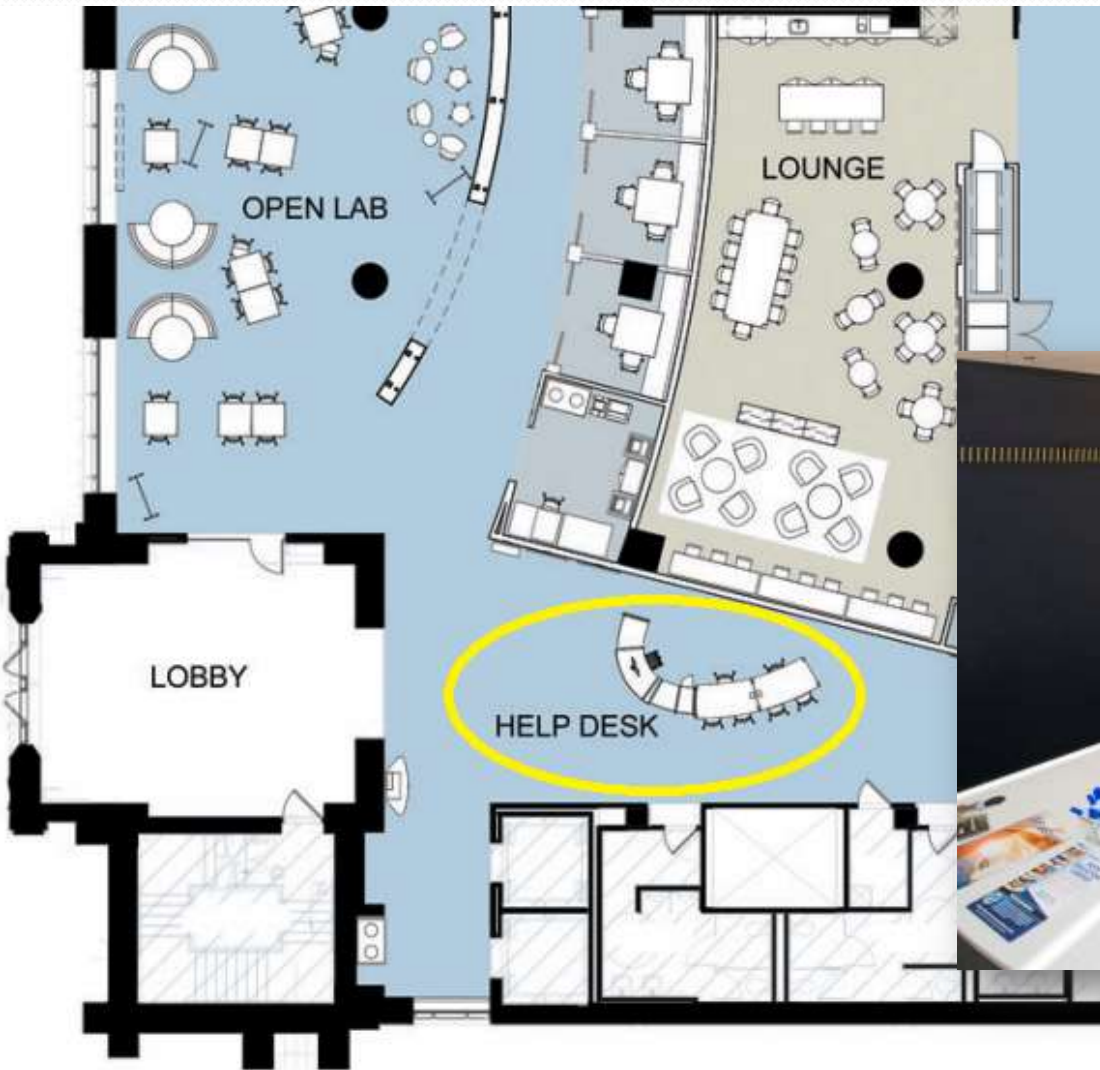

The / EDGE

The Ruppert Commons for
Research + Technology + Collaboration

Kiosk

Events

Reserve
Spaces

Map

Staff

Get Help

Events

Reserve
Spaces

Map

Staff

Get Help

RESERVE A ROOM

is 3:29 PM

February 2015						
Su	Mo	Tu	We	Th	Fr	Sa
1	2	3	4	5	6	7
8	9	10	11	12	13	14
15	16	17	18	19	20	21
22	23	24	25	26	27	28

Confirmed Bookings

Project Room 1
10:00am Linn
1:00pm Sit
3:00pm Eagan
7:00pm Clean at pickup and give
9:00pm Drive

Project Room 2
1:30pm Without Inert Lab Writing Group
2:30pm MMS 490 group project
7:00pm Seminar Meeting

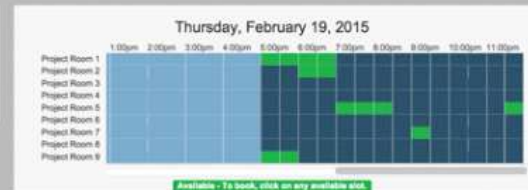

DigiCenter

Scanner / Kopierer / Drucker



Offene, flexible Sitz- und Steh- konfigurationen

Jones Open Lab & Breakouts

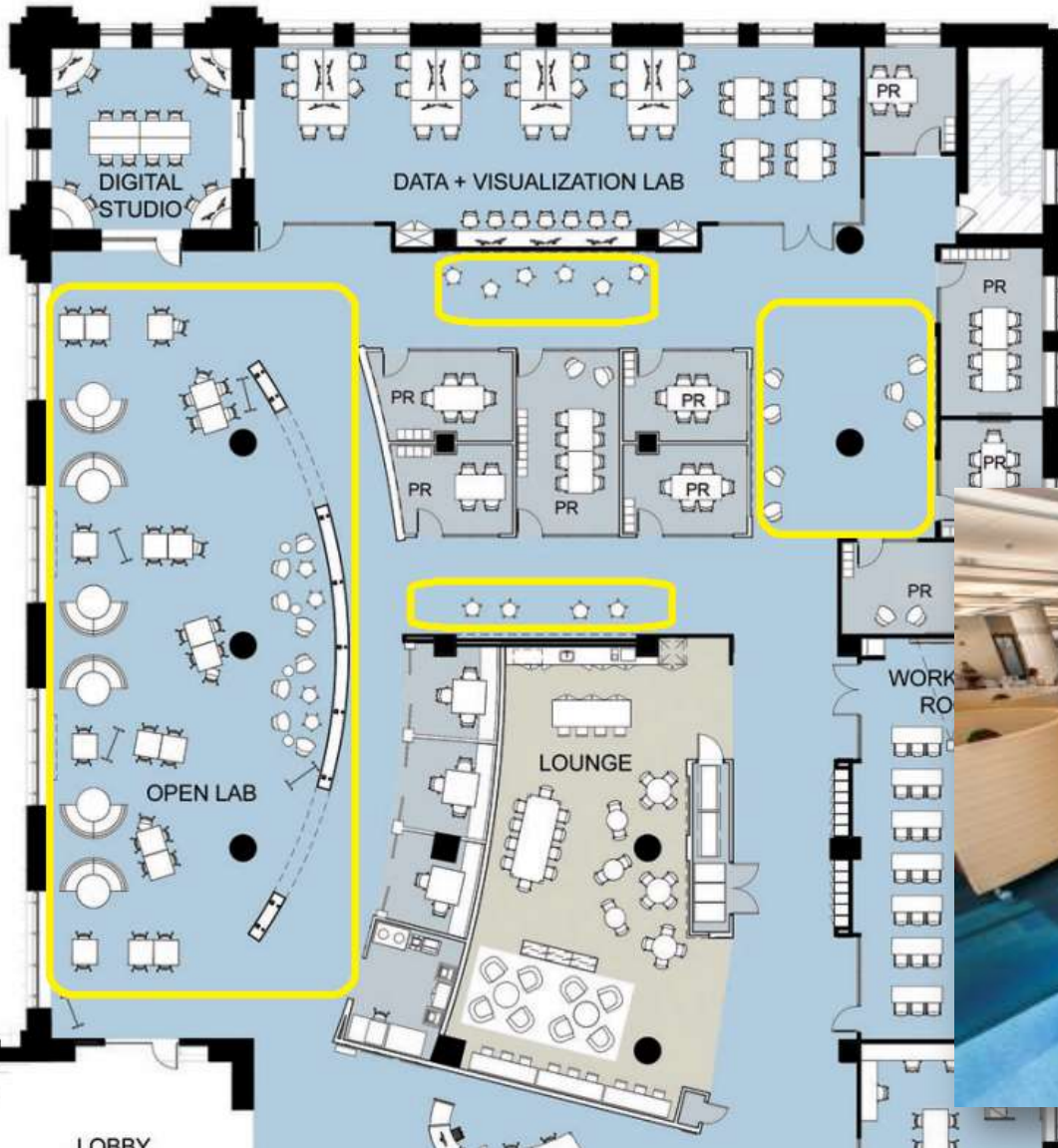

Gruppenarbeitsräume

Reservierung nicht erforderlich



Labor digitale Wissenschaften

Murthy Digital Studio

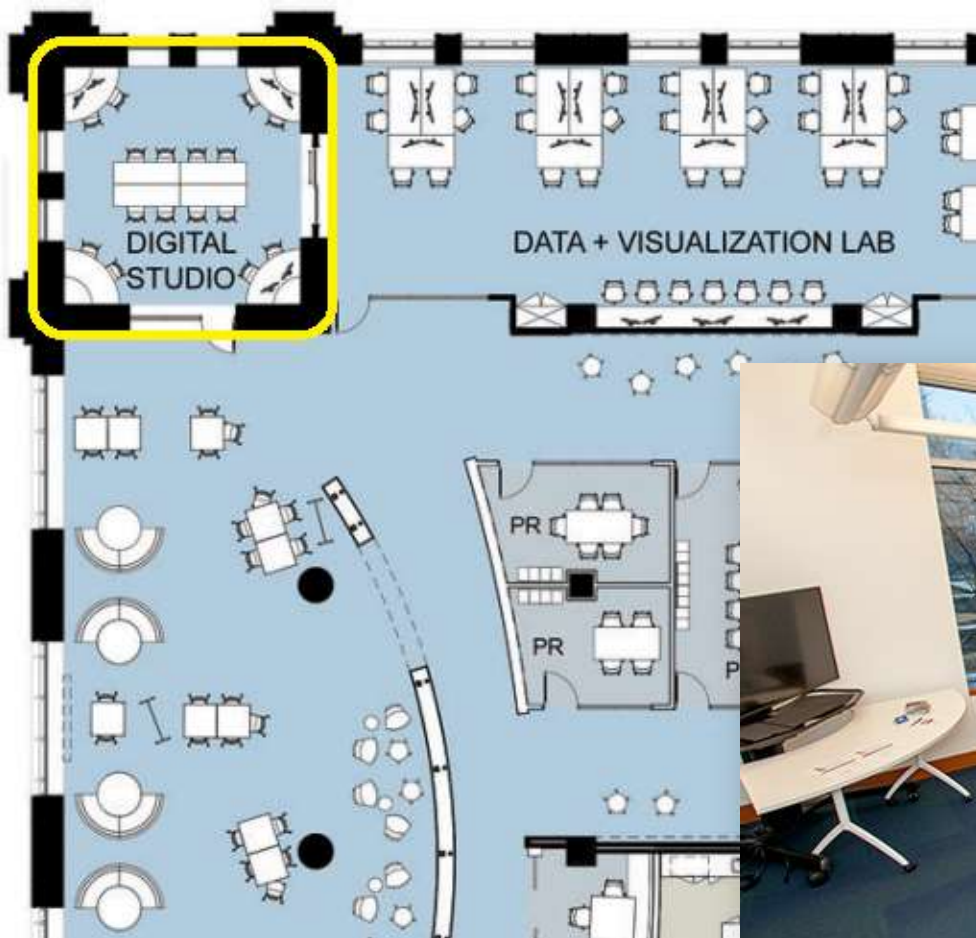

Labor Daten- management

Brandaleone Lab for Data &
Visualization Services

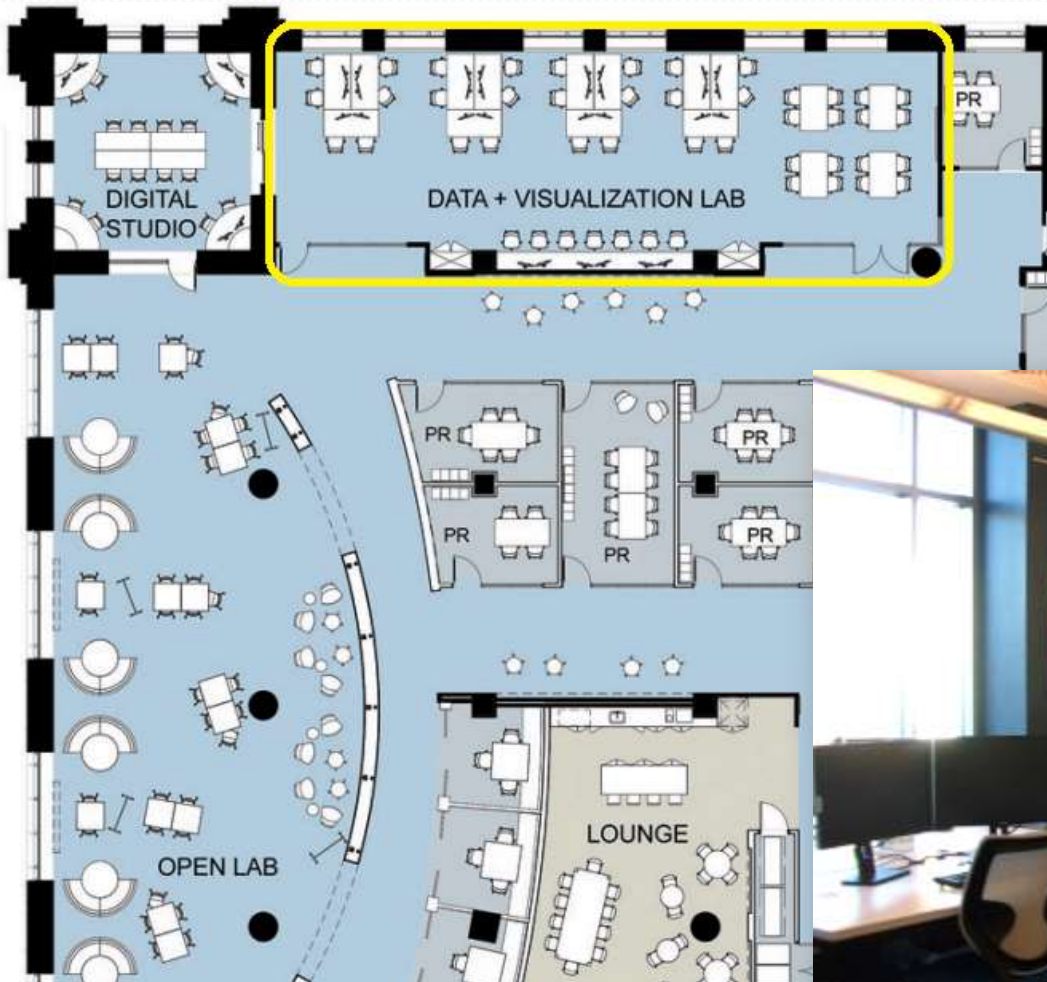

Software / Hardware

Software Tools

Statistical Software

- Stata 14
- R, RStudio
- SAS 9.3
- Matlab R2014b
- StatTransfer
- QSR Nvivo

Mapping Software

- ArcGIS 10.3.1
- Google Earth Pro

Visualization Software

- Tableau Public 8.2
- Adobe Design Standard CS6 (Photoshop, Illustrator, In-Design, Acrobat Pro)
- Inkscape SVG editor

Data Wrangling (normalizing)

- OpenRefine
- MS Excel

Lab Hardware

12 Dell Precision T1650 workstations

- Operating System: Windows 7 64-bit
- Processor: Intel Xeon 3.5 GHz, 4 core
- Monitors: Two 24" monitors, 16:10 aspect ratio
- Memory: 16GB RAM
- Drive Capacity: 1TB scratch storage (drive letter "D")

[3 Bloomberg Financial Workstations](#)

1 Fujitsu FI-6230Z Scanner with flatbed and automatic document feeder

- Scanner uses up to A4-sized paper

Projekträume

Langzeitreservierung und Reservierung vor Ort

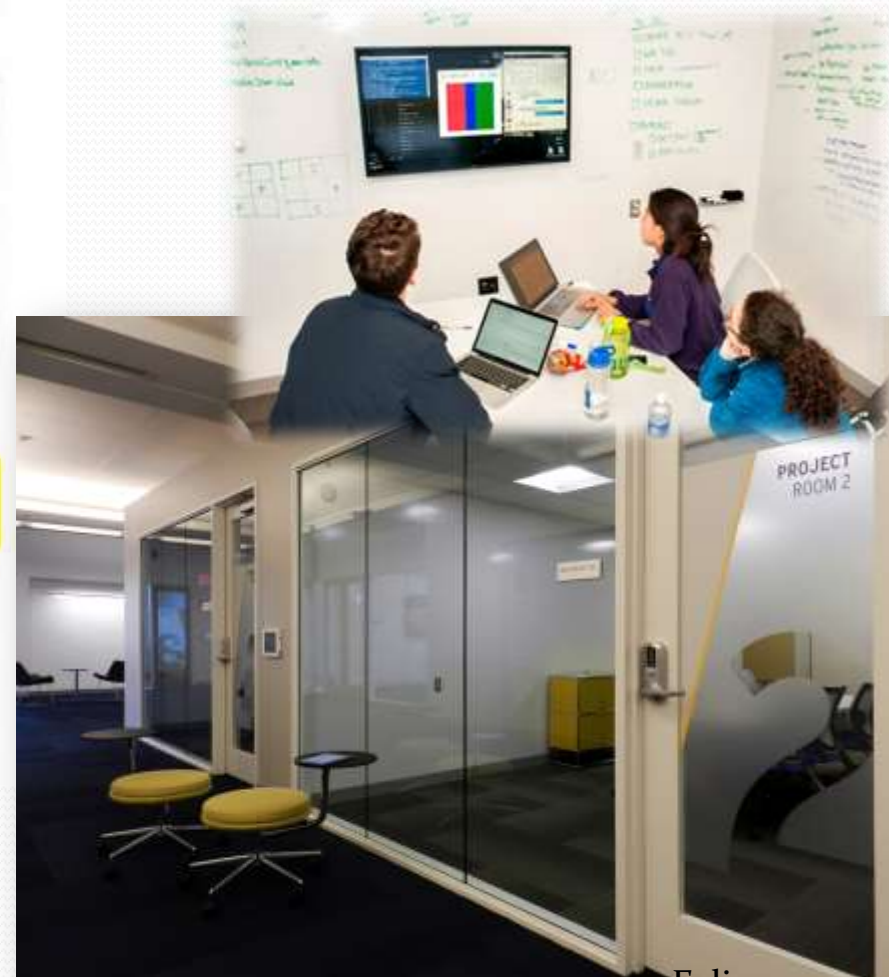
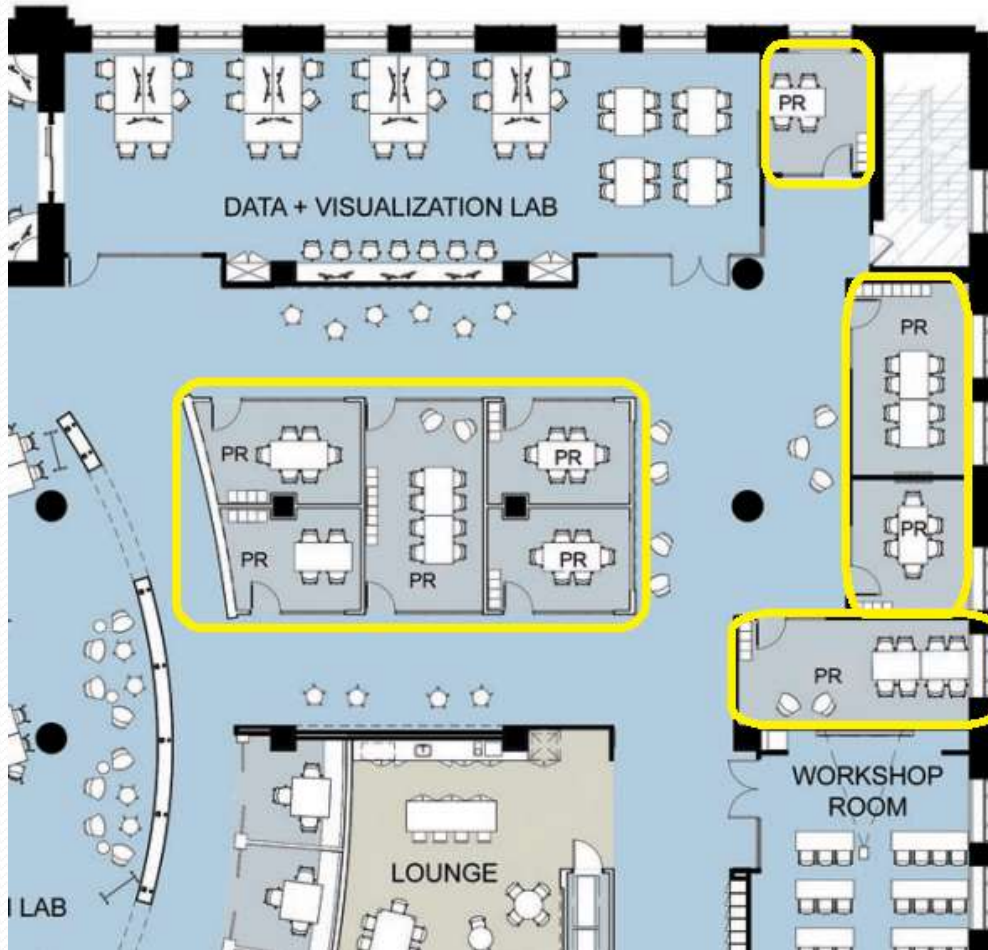

Workshop- und Vortragsraum

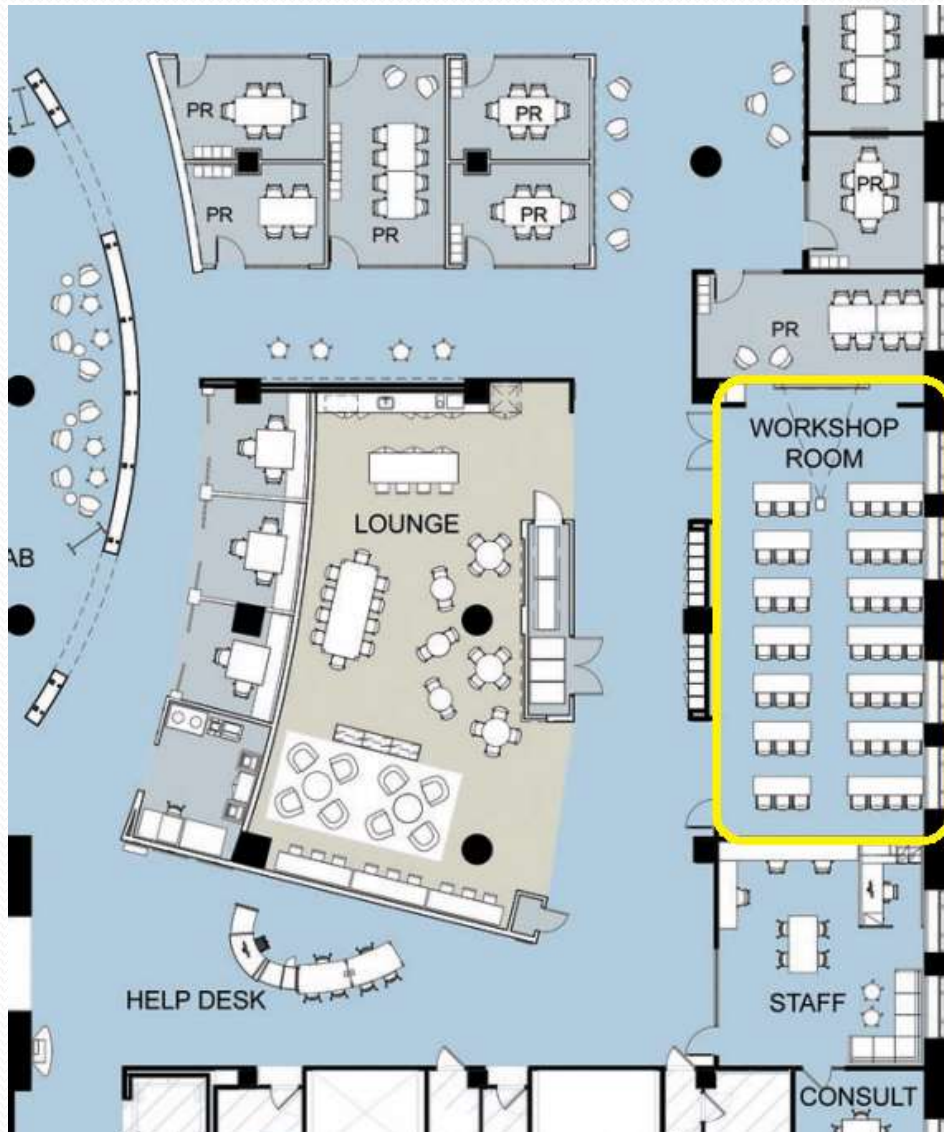

Lounge



Büros & Beratungsraum

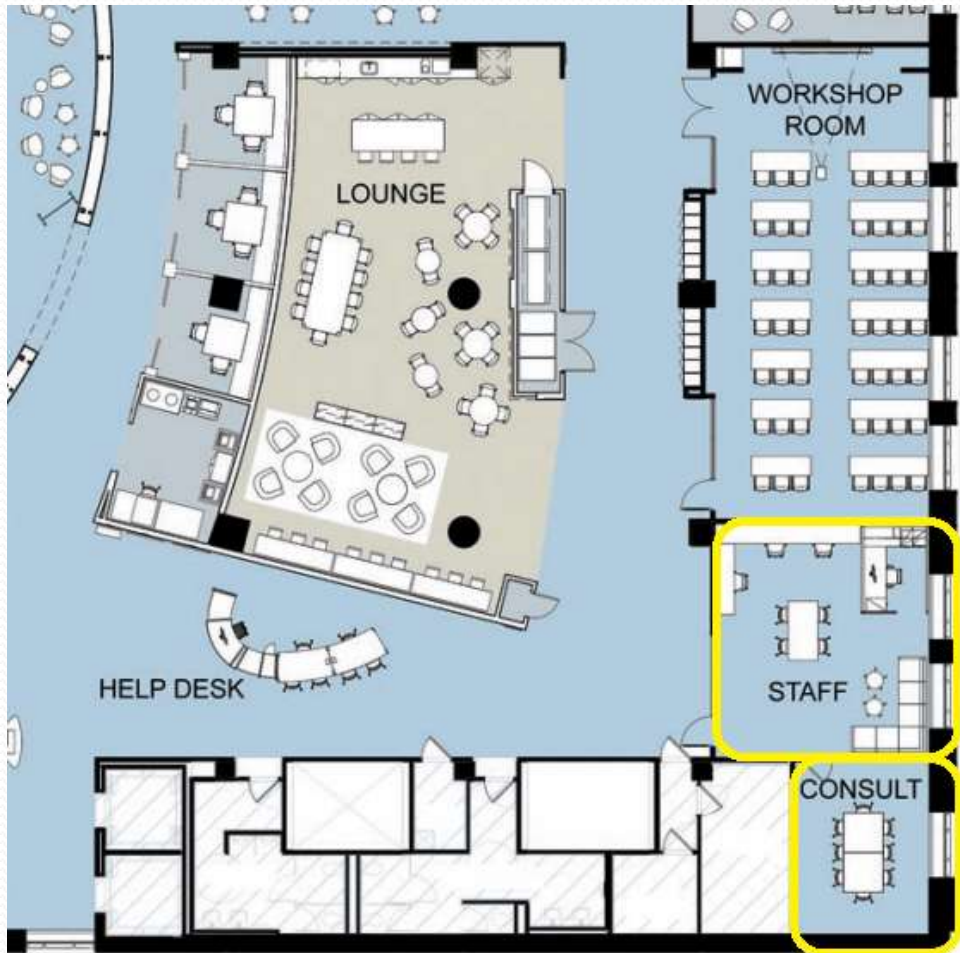

Bausteine der Forschungs-Commons

1. **Eingangshalle**
2. **Servicedesk / Auskunft** (mit Online-Kiosk)
3. **DigiCenter / Kopieren / Drucken**
4. **Offener Raum mit flexiblen Sitz- und Stehkonfigurationen**
5. **Breakout** (alternative Sitz- und Stehkonfigurationen in Verbindung mit, aber außerhalb von Projekträumen)
6. **Gruppenarbeitsräume** (keine Reservierung erforderlich)
7. **Labor digitale Wissenschaften**
8. **Labor Datenmanagement**
9. **Projekträume** (Langzeitreservierung + Reservierung vor Ort)
10. **Workshop - & Vortragsraum**
11. **Lounge** (auch für Empfänge)
12. **Mitarbeiterbüro**
13. **Beratungsraum/ Konsultation**

Digitale Wissenschaften im Research Triangle in North Carolina

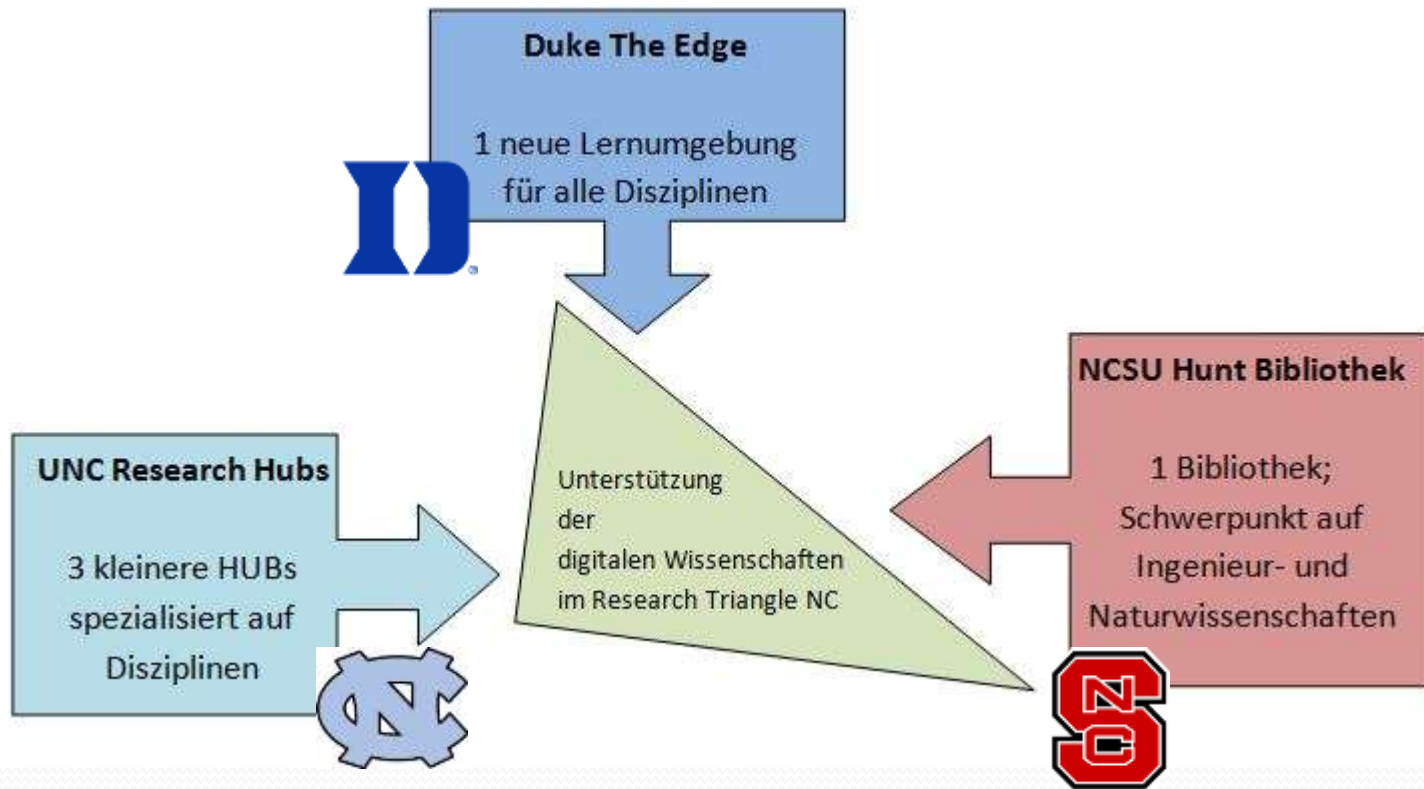

North Carolina State University - Hunt Library (Eröffnung 2013) <http://www.lib.ncsu.edu/huntlibrary>



4

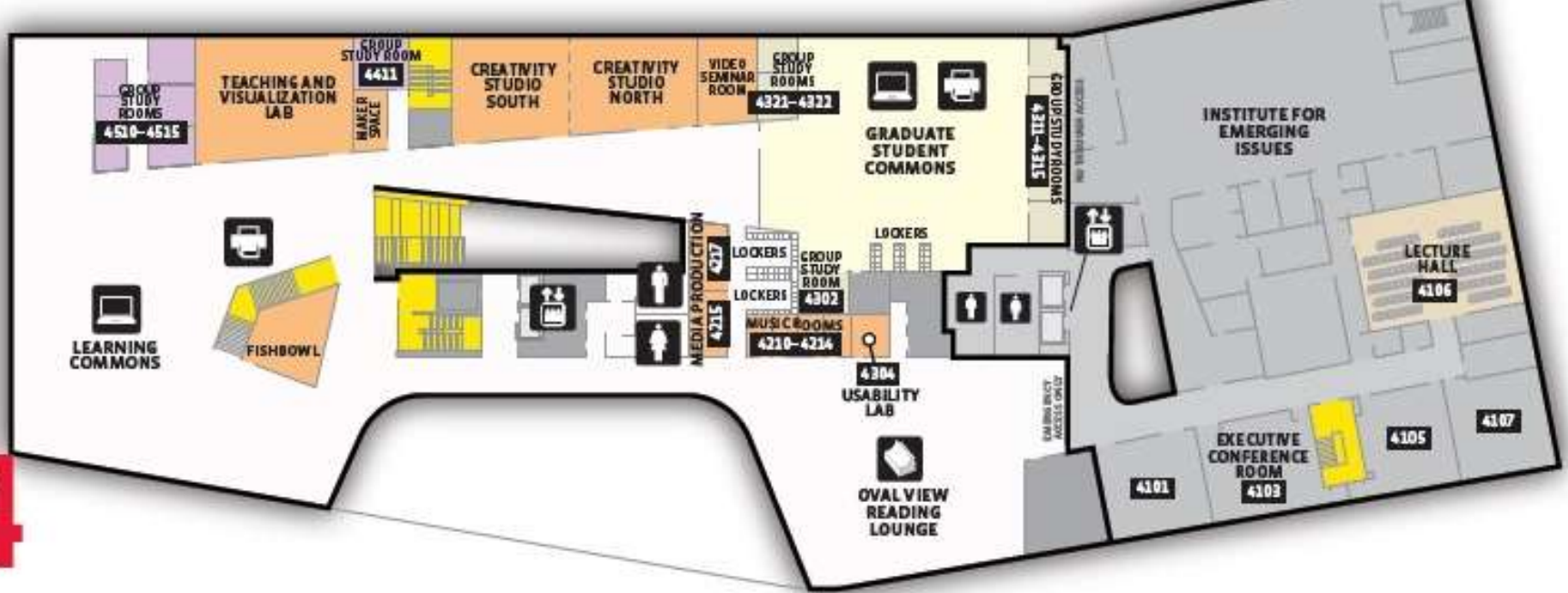

3

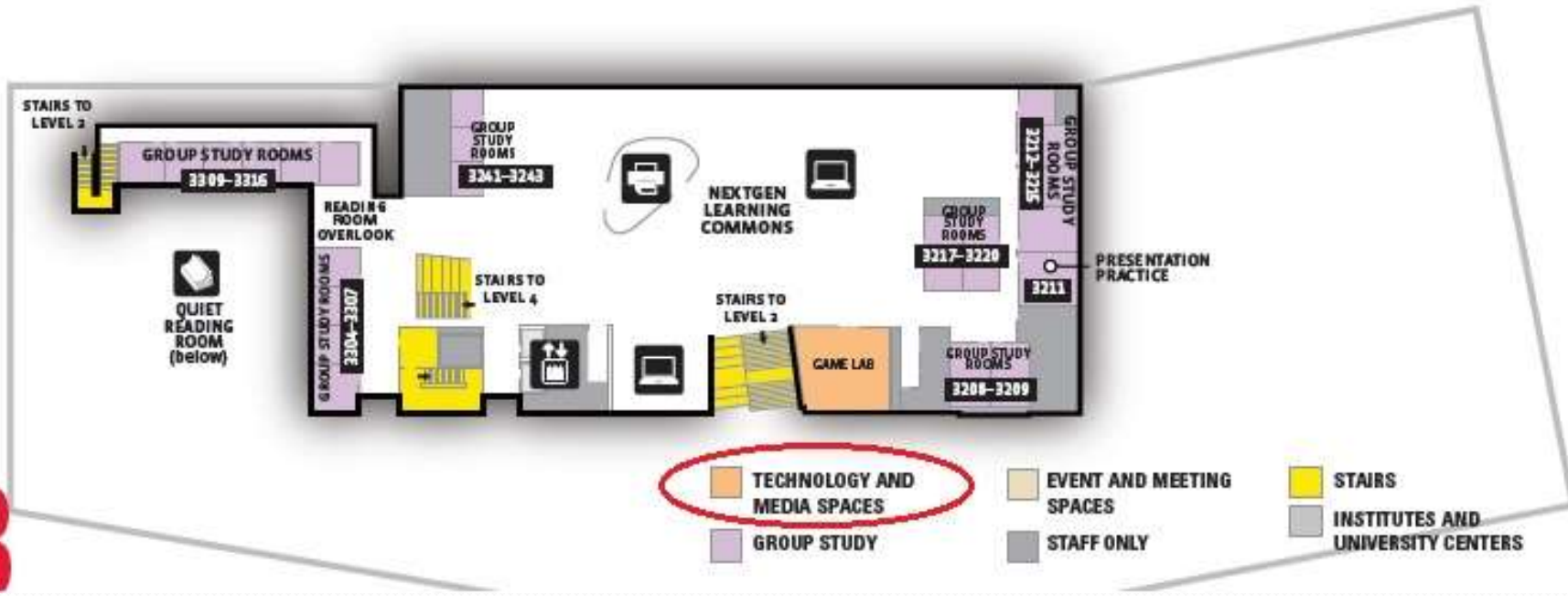

UNC Davis Library, Floor 2

(Eröffnung 1984/2014) <http://library.unc.edu/davis/>



OPEN GALLERY

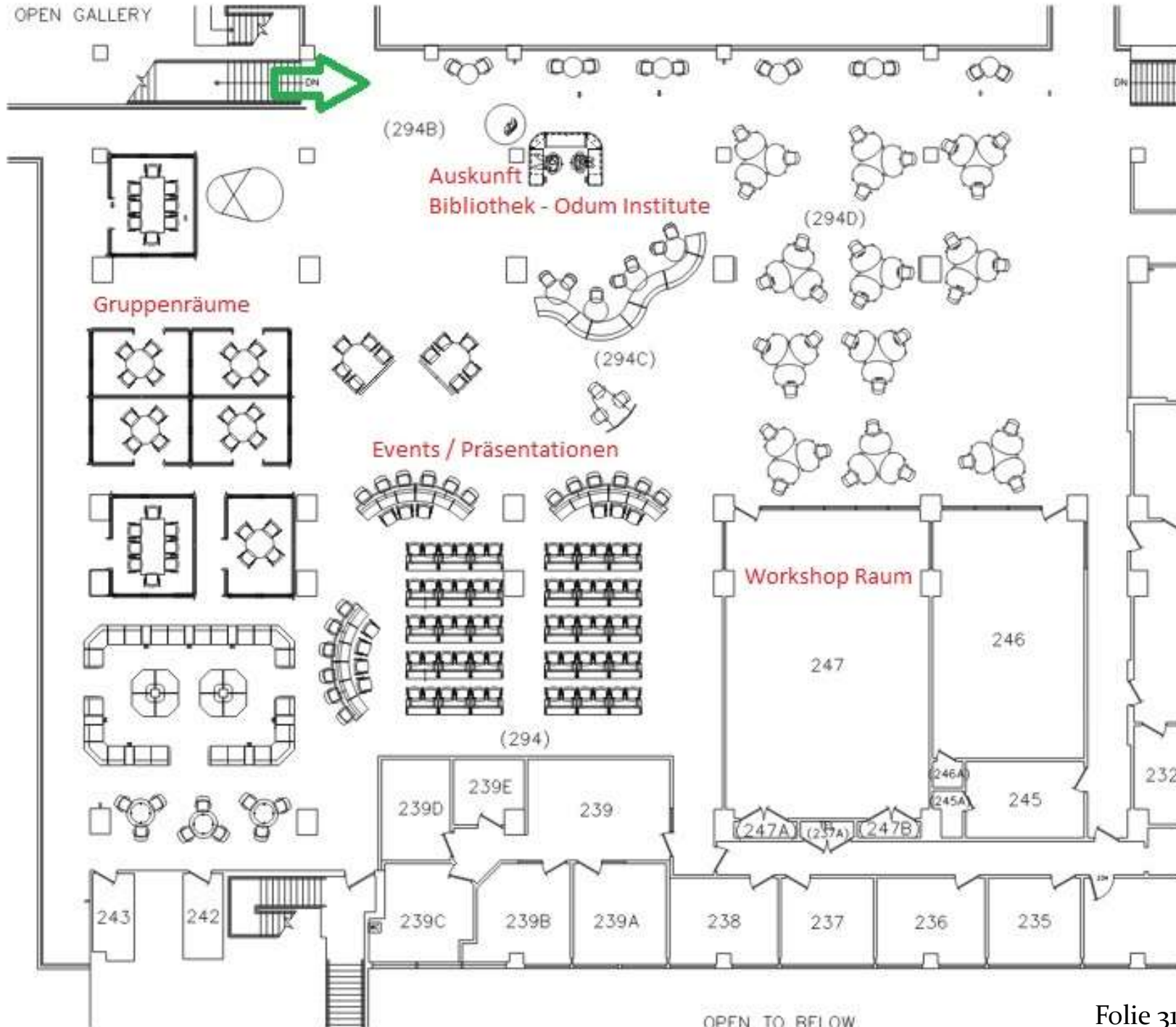

Flexible Gruppenarbeitsplätze

Duke



NCSU



UNC



Projekträume

Duke



NCSU



UNC



Workshop- und Vortragsräume

Duke



NCSU



UNC



Möblierung

Duke



NCSU



UNC



Labore

Duke



NCSU



UNC



Programm

Duke

NCSU

UNC

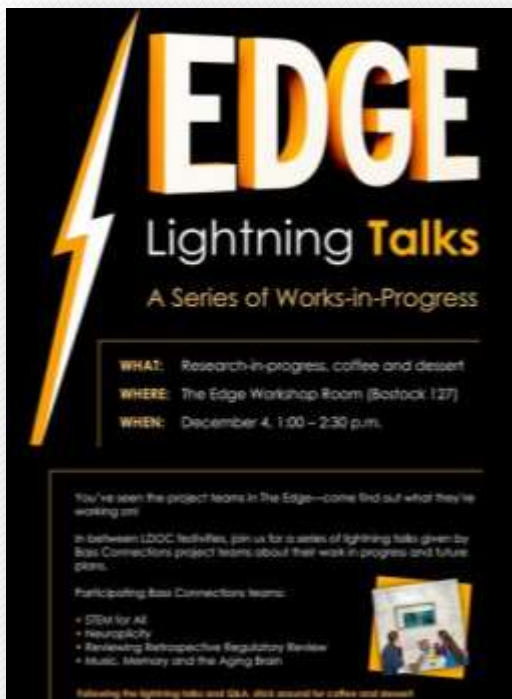

EDGE
Lightning Talks
A Series of Works-in-Progress

WHAT: Research-in-progress, coffee and dessert
WHERE: The Edge Workshop Room (Bostock 127)
WHEN: December 4, 1:00 – 2:30 p.m.

You've seen the project teams in the Edge—come find out what they're working on!

In between LDOC activities, join us for a series of lightning talks given by Bass Connections project teams about their work in progress and future plans.

Participating Bass Connections teams:

- DSM for All
- NeuroPACy
- Reviewing Retrospective Regulatory Review
- Music, Memory and the Aging Brain

Following the lightning talks and Q&A, there'll be coffee and dessert!

Coffee & Viz - Network Visualization Lightning Talks



When

February 19, 2016
9:30am - 10:30am

Where

› Teaching and Visualization Labs at the James B. Hunt Jr. Library

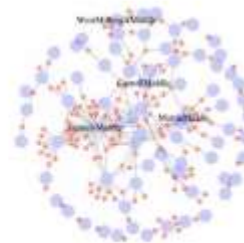

Humanitarian
MAPATHON
in support of Humanitarian OpenStreetMap (hotsm.org)

When disaster strikes, responders have to get there fast. Yet, no accurate maps exist for large parts of the world. Join volunteers in the Davis Library Research Hub to fill in critical blanks.

Davis Library Research Hub (2nd floor)
Thursday, October 22, 2015 | 5 - 7 p.m.

University of North Carolina at Chapel Hill | library.unc.edu
No experience needed
Participants are encouraged to bring a laptop computer.
Information: Shonda.Henley@unc.edu



An illustration showing four people sitting around a table, each working on a laptop. In the background, there is a world map. The scene is set in a blue environment, suggesting a collaborative workspace. The people are shown from a top-down perspective, with their heads and hands visible as they work.

UNC
HUB

Zur Abwechslung und Zerstreuung

Duke



NCSU



UNC



Servicedesk

Duke



NCSU



UNC



Langzeitprojekte



Apply for Space in The Edge

Complete this form to request a long-term (weeks or months) project space in The Edge.

Note: one-off meetings should be scheduled using the touchscreen or the ipads located in The Edge.

Questions or need more information about The Edge? Contact edge@duke.edu.

When do you need space and for how long? Please be as specific as possible regarding start and end dates.

Start Date (mm/dd/yy)

End Date (mm/dd/yy)

Days/Time to reserve room (ex: Mondays 3:00-4:00 PM)

Preferred room size

Projektschließfächer

Duke



Bildschirme / Projektionen

Duke



NCSU



UNC



Präsentieren

NCSU



UNC



AV Medienbearbeitung + Usabilityanalyse

NCSU

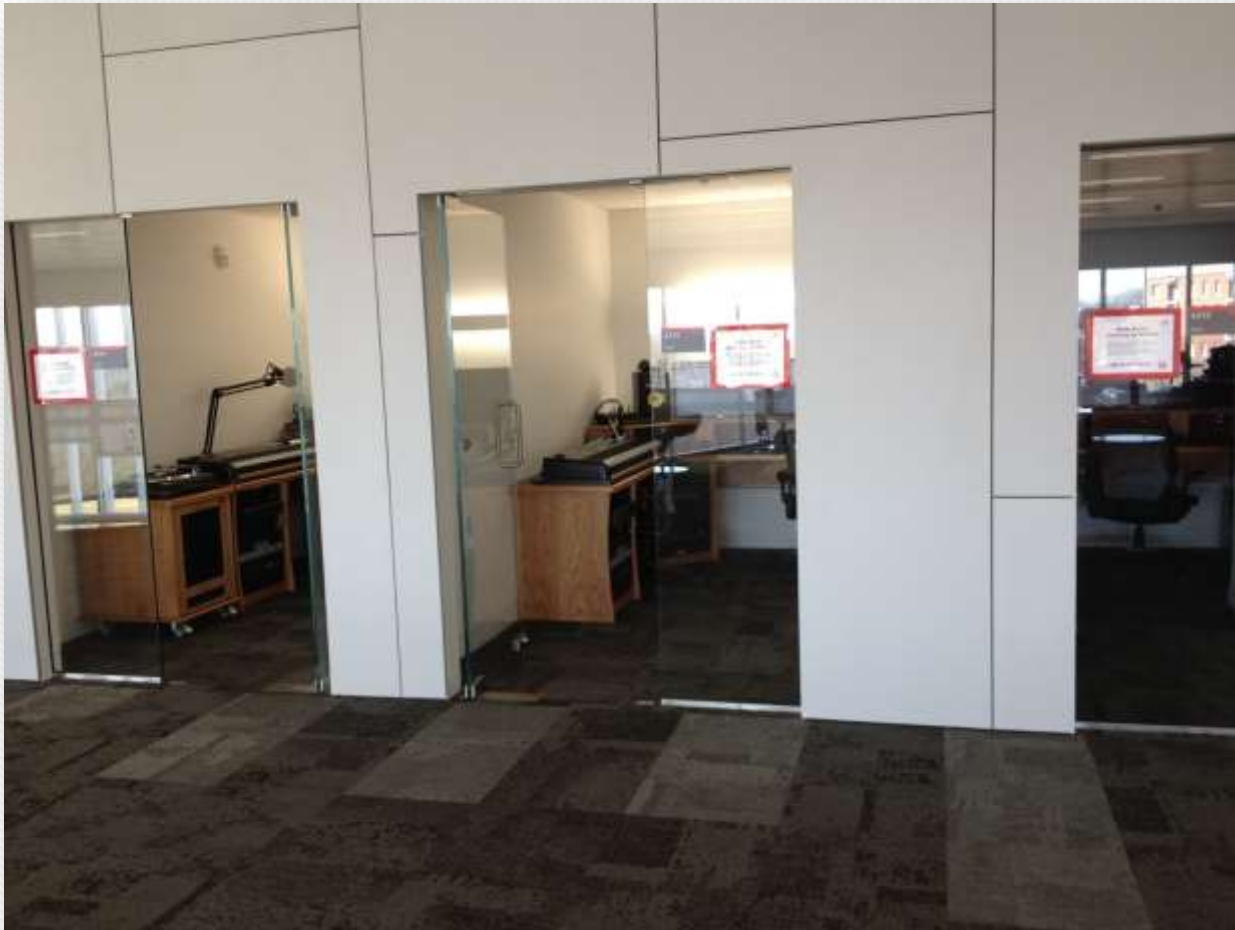

Sandbox

NCSU



Gaming

NCSU



Zusammenfassung

Gemeinsamkeiten	Unterschiede
• Gruppenarbeitsplätze	• Servicedesk
• Projekträume	• Langzeitprojekte
• Workshop- und Vortragsräume	• Projektschließfächer
• flexible Möblierung	• Bildschirme / Projektion
• Labore	• Präsentieren
• Programm	• AV-Medienbearbeitung + Usabilityanalyse
• Abwechslung / Zerstreuung	• Sandbox
	• Gaming

Anekdoten / Planung vs. Realität

- praktische Herausforderungen
Steckdosen, beschreibbare Wände,
Waschbecken, Schlüssel, Licht, Dekoration
- hochauflösende Bildschirme
aufwändig
- Lärmpegel
wird als positiv empfunden

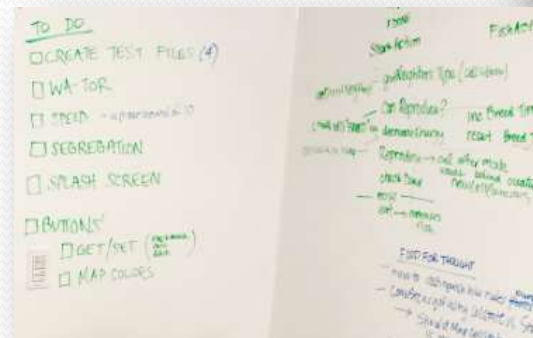

Ausgewählte Projekte

- **Bass Connections**

Studenten sollen lernen interdisziplinär und kollaborativ an global relevanten Themen zu forschen; mehrere Arbeitsgruppen mit verschiedenen Fachbereichen

- **Design for America**

Studenten untersuchen die Problematik der häuslichen Gewalt und versuchen Strategien zur Prävention zu entwickeln

- **Wilbourn Lab Writing Group**

Studenten forschen über den Spracherwerb von Kindern und wie dieser durch kulturelle Unterschiede beeinflusst wird

- **Project Vox**

Informationen und Lehrpläne über in der Philosophie unterrepräsentierte Personen werden online verfügbar gemacht (derzeit Philosophinnen der Frühen Neuzeit)

Projektbeispiel – Project Vox

PROJECT VOX

[Home »](#)

[Teaching](#)

[Images](#)

[Timeline](#)

[Philosopher »](#)

Dropdown of women philosophers

Cavendish

Conway

Du Châtelet

Masham

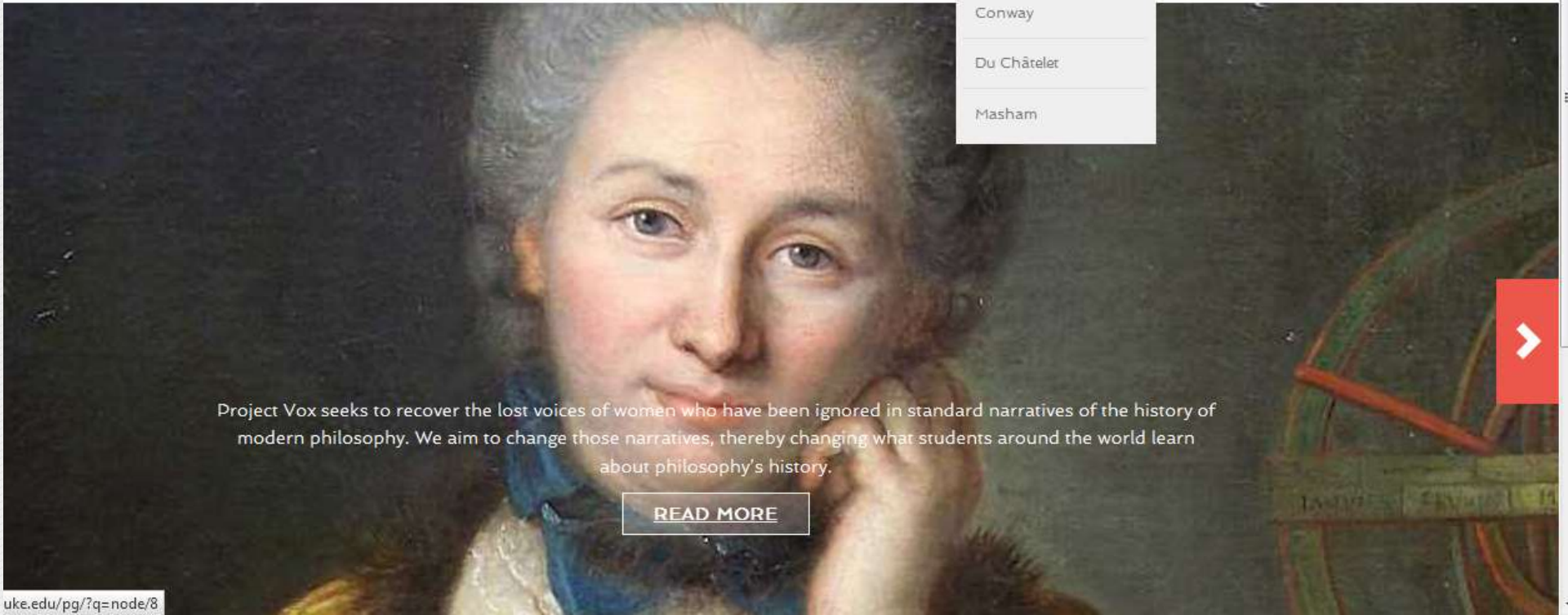

Project Vox seeks to recover the lost voices of women who have been ignored in standard narratives of the history of modern philosophy. We aim to change those narratives, thereby changing what students around the world learn about philosophy's history.

[READ MORE](#)

uke.edu/pg/?q=node/8

<http://projectvox.library.duke.edu/pg/>

Project Vox

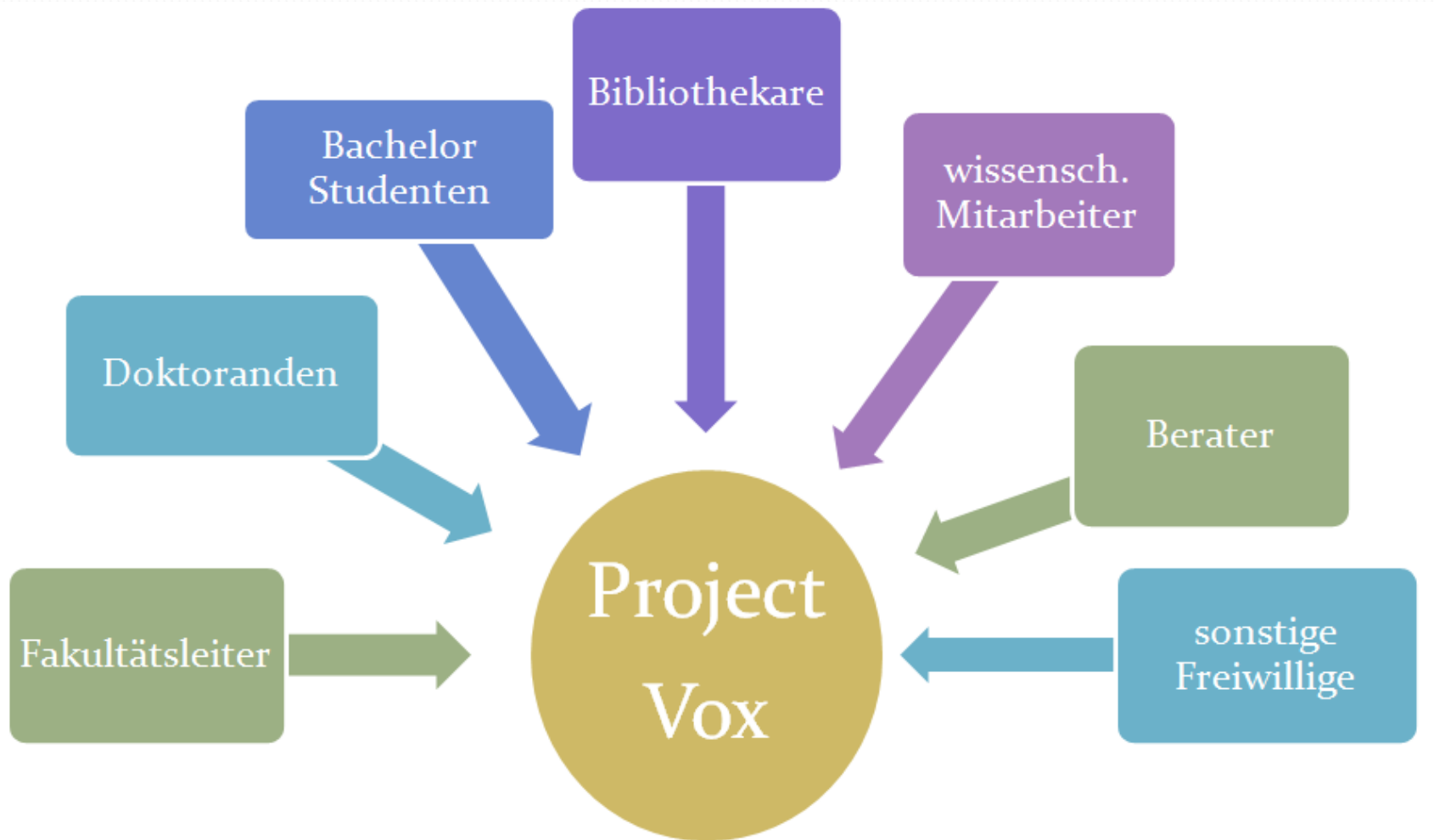

The Real Experts

Thank you for sharing documentation and photographs. Thank you for tours, discussions, and advice.

Duke

- Brittany Wofford and the Edge Management Team
- Cheryl Thomas and the Project Vox Team
- Deborah Jakubs and Duke University Libraries Administration
- Debra Kurtz
- Emily Daly
- Irish Turrentine and Duke University Libraries Human Resources
- Jakob Norberg and the German Studies Department
- Jean Ferguson
- Jim Tuttle
- Joel Herndon and the Data Management Department

- Kim Duckett and the Research Services Department
- Kristina Troost and the International and Area Studies Department
- Linda Daniel
- Liz Milewicz and the Digital Scholarship Services Team
- Mark Zupan

NCSU

- Markus Wust
- Darby Orcutt

UNC

- Libby Chenault
- Michele Matz Hayslett